

HTP DOOR

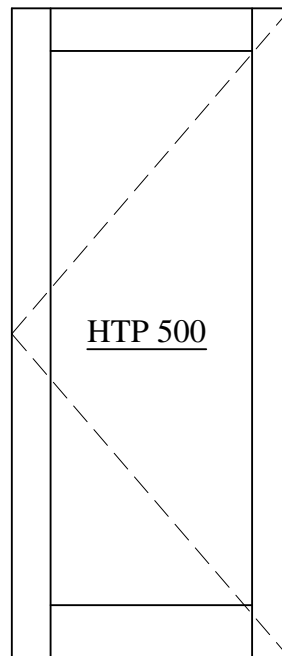

KEY FEATURES

- High Performance Thermal Break
- Accommodates 1" double or 1- $\frac{1}{2}$ " triple glazing units
- 2 $\frac{1}{2}$ ", 3 $\frac{3}{4}$ " and 5" stiles available
- 1", 4 $\frac{1}{8}$ ", 5 $\frac{1}{2}$ " and 7" top/bottom/mid-rails available
- Compatible with curtain wall & 655 framing
- Narrow, medium and wide stiles are cross-compatible
- Available in anodized and painted finishes

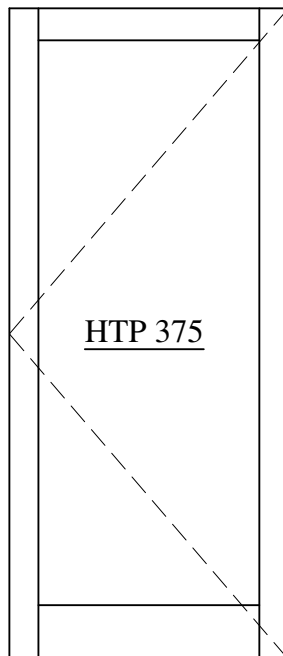
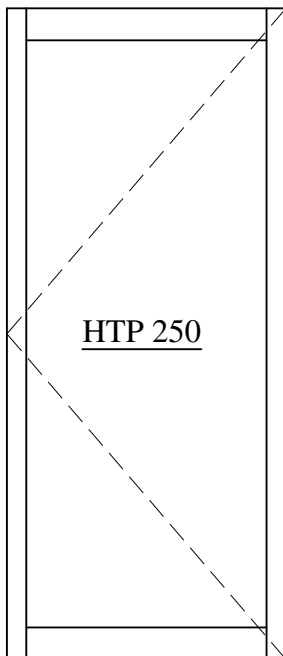

WINDSPEC INC.

MANUFACTURERS OF HIGH PERFORMANCE 'WINDSPEC' WINDOWS
ALUMINUM ENTRANCE SYSTEMS AND ARCHITECTURAL PANELS
1310 CREDITSTONE RD, CONCORD, ONTARIO L4K 5T7
Telephone (905) 738 -8311 Fax (905) 738 - 6188

FEBRUARY 2017

HTP DOOR

TABLE OF CONTENTS

DOOR ORDERING INFORMATION _____	003
GLAZING INFILL OPTIONS _____	004
NARROW STILE IN HTP 5500 _____	006
MEDIUM STILE IN HTP 5500 _____	008
WIDE STILE IN HTP 5500 _____	010
NARROW STILE IN 655 FRAMING _____	012
MEDIUM STILE IN 655 FRAMING _____	014
WIDE STILE IN 655 FRAMING _____	016
TRIPLE GLAZED HTP DOOR IN HTP 5500 _____	018
HTP DOOR STILES AND HORIZONTAL RAILS _____	020



WINDSPEC INC.

MANUFACTURERS OF HIGH PERFORMANCE 'WINDSPEC' WINDOWS
ALUMINUM ENTRANCE SYSTEMS AND ARCHITECTURAL PANELS
1310 CREDITSTONE RD, CONCORD, ONTARIO L4K 5T7
Telephone (905) 738 -8311 Fax (905) 738 - 6188

FEBRUARY 2017

HTP DOOR

DOOR ORDERING INFORMATION

Standard Hardware

- 3 Butt hinges (NRP) - 4 $\frac{1}{2}$ " x 4"
 - Stainless steel for exterior doors
 - Standard steel for interior doors
- M.S. Lock (Adams Rite 1850)
 - Thumb turn
 - Cylinder
- Pair to have flush bolts on in-active
- Push bar / pull handle
- 4" threshold
- Door sweep

Standard Door Opening Size

- Door opening for single door is 36" x 84"
- Door opening for pair door is 72" x 84"
- Actual door size will be smaller to allow for clearances

Standard Finishes

- Standard anodized doors:
 - Clear 0.0004 and #40 Bronze are typically stocked
 - Light bronze, champagne and black anodized are available

Custom painted finishes are available

Door Swings

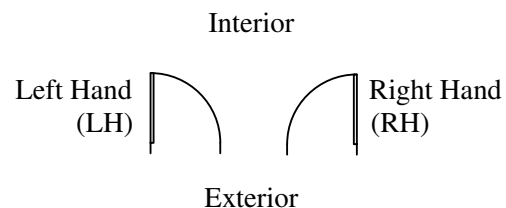
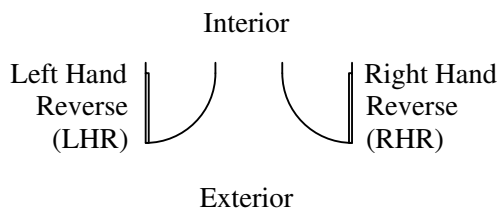





WINDSPEC INC.

MANUFACTURERS OF HIGH PERFORMANCE 'WINDSPEC' WINDOWS
ALUMINUM ENTRANCE SYSTEMS AND ARCHITECTURAL PANELS
1310 CREDITSTONE RD, CONCORD, ONTARIO L4K 5T7
Telephone (905) 738 -8311 Fax (905) 738 - 6188

FEBRUARY 2017

HTP DOOR

GLAZING INFILL OPTIONS

Glazing Options	Exterior Glass Stop	Interior Glass Stop
1" Glazing (Double Glazed)	 C-25012	 C-20027
1 1/2" Glazing (Triple Glazed)	 C-20027	 C-20027

GLASS SIZE CALCULATION

****Based on butt hinges at 1/2" threshold****

Door Type	Glass W	Glass H	Standard Glass Size (36" x 84")
<u>250 Single</u> (2 1/2" Stile, 4 1/8" Top & Bottom Rail)	-5 11/16"	-9 9/16"	30 5/16" x 74 7/16"
<u>250 Pair</u> (2 1/2" Stile, 4 1/8" Top & Bottom Rail)	2 x -5 11/16"	-9 9/16"	2 @ 30 5/16" x 74 7/16"



WINDSPEC INC.
MANUFACTURERS OF HIGH PERFORMANCE 'WINDSPEC' WINDOWS
ALUMINUM ENTRANCE SYSTEMS AND ARCHITECTURAL PANELS
1310 CREDITSTONE RD, CONCORD, ONTARIO L4K 5T7
Telephone (905) 738 -8311 Fax (905) 738 - 6188

FEBRUARY 2017

HTP DOOR

GLAZING INFILL OPTIONS

Door Type	Glass W	Glass H	Standard Glass Size (36" x 84")
<u>375 Single</u> (3 $\frac{3}{4}$ " Stile, 4 $\frac{1}{8}$ " Top, 7" Bottom Rail)	-8 $\frac{3}{16}$ "	-12 $\frac{7}{16}$ "	27 $\frac{13}{16}$ " x 71 $\frac{9}{16}$ "
<u>375 Pair</u> (3 $\frac{3}{4}$ " Stile, 4 $\frac{1}{8}$ " Top, 7" Bottom Rail)	2 x -8 $\frac{3}{16}$ "	-12 $\frac{7}{16}$ "	2 @ 27 $\frac{13}{16}$ " x 71 $\frac{9}{16}$ "
<u>500 Single</u> (5" Stile, 5 $\frac{1}{2}$ " Top, 7" Bottom Rail)	-10 $\frac{11}{16}$ "	-13 $\frac{13}{16}$ "	25 $\frac{5}{16}$ " x 70 $\frac{3}{16}$ "
<u>500 Pair</u> (5" Stile, 5 $\frac{1}{2}$ " Top, 7" Bottom Rail)	2 x -10 $\frac{11}{16}$ "	-13 $\frac{13}{16}$ "	2 @ 25 $\frac{5}{16}$ " x 70 $\frac{3}{16}$ "



WINDSPEC INC.

MANUFACTURERS OF HIGH PERFORMANCE 'WINDSPEC' WINDOWS
ALUMINUM ENTRANCE SYSTEMS AND ARCHITECTURAL PANELS
1310 CREDITSTONE RD, CONCORD, ONTARIO L4K 5T7
Telephone (905) 738 -8311 Fax (905) 738 - 6188

FEBRUARY 2017

HTP DOOR

NARROW STILE IN HTP 5500

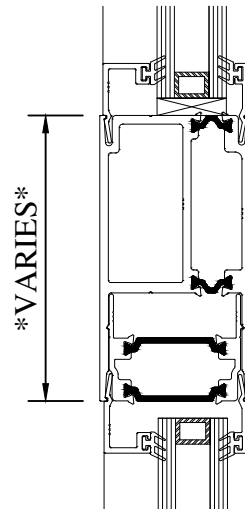
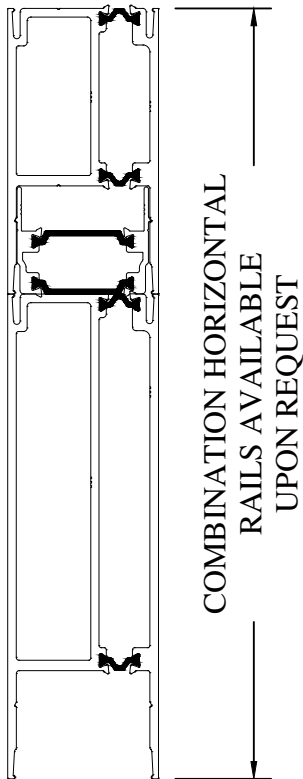
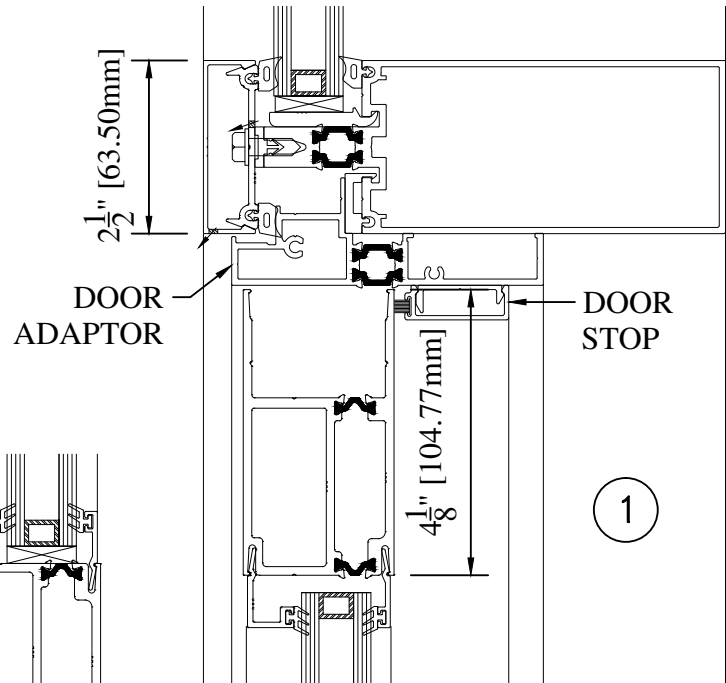
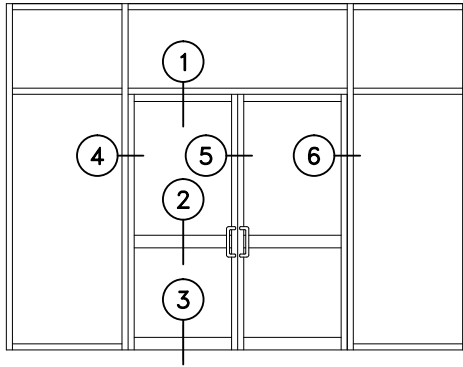

2

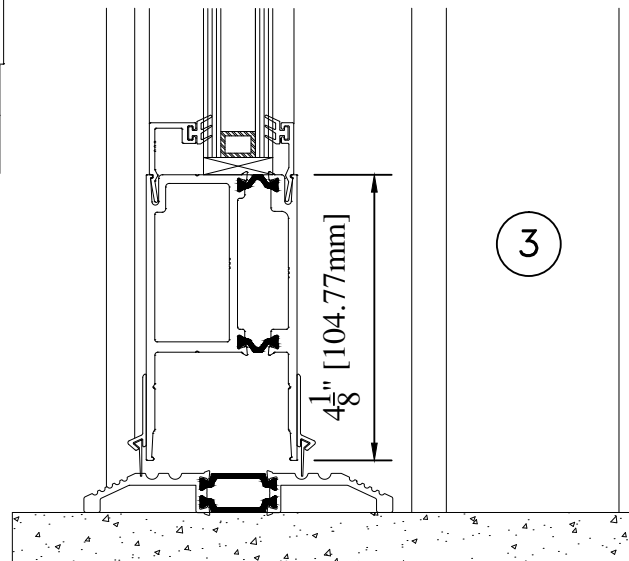

WINDSPEC INC.
MANUFACTURERS OF HIGH PERFORMANCE 'WINDSPEC' WINDOWS
ALUMINUM ENTRANCE SYSTEMS AND ARCHITECTURAL PANELS
1310 CREDITSTONE RD, CONCORD, ONTARIO L4K 5T7
Telephone (905) 738 -8311 Fax (905) 738 - 6188

FEBRUARY 2017

HTP DOOR

NARROW STILE IN HTP 5500

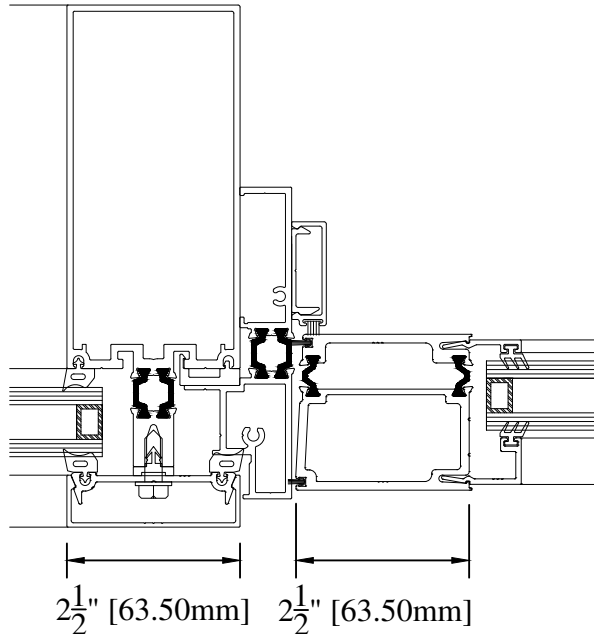

4

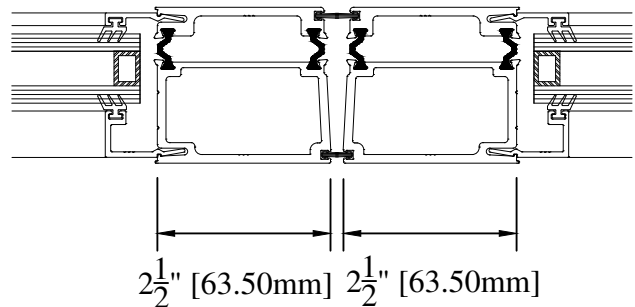

5

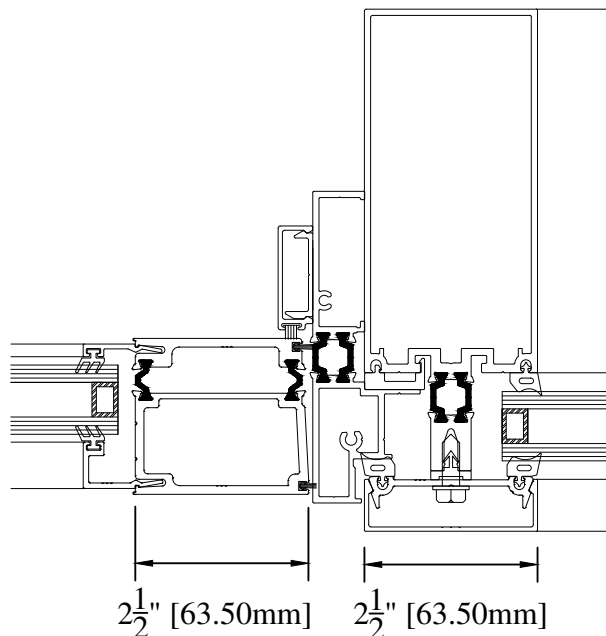

6



WINDSPEC INC.
MANUFACTURERS OF HIGH PERFORMANCE 'WINDSPEC' WINDOWS
ALUMINUM ENTRANCE SYSTEMS AND ARCHITECTURAL PANELS
1310 CREDITSTONE RD, CONCORD, ONTARIO L4K 5T7
Telephone (905) 738 -8311 Fax (905) 738 - 6188

FEBRUARY 2017

HTP DOOR

MEDIUM STILE IN HTP 5500

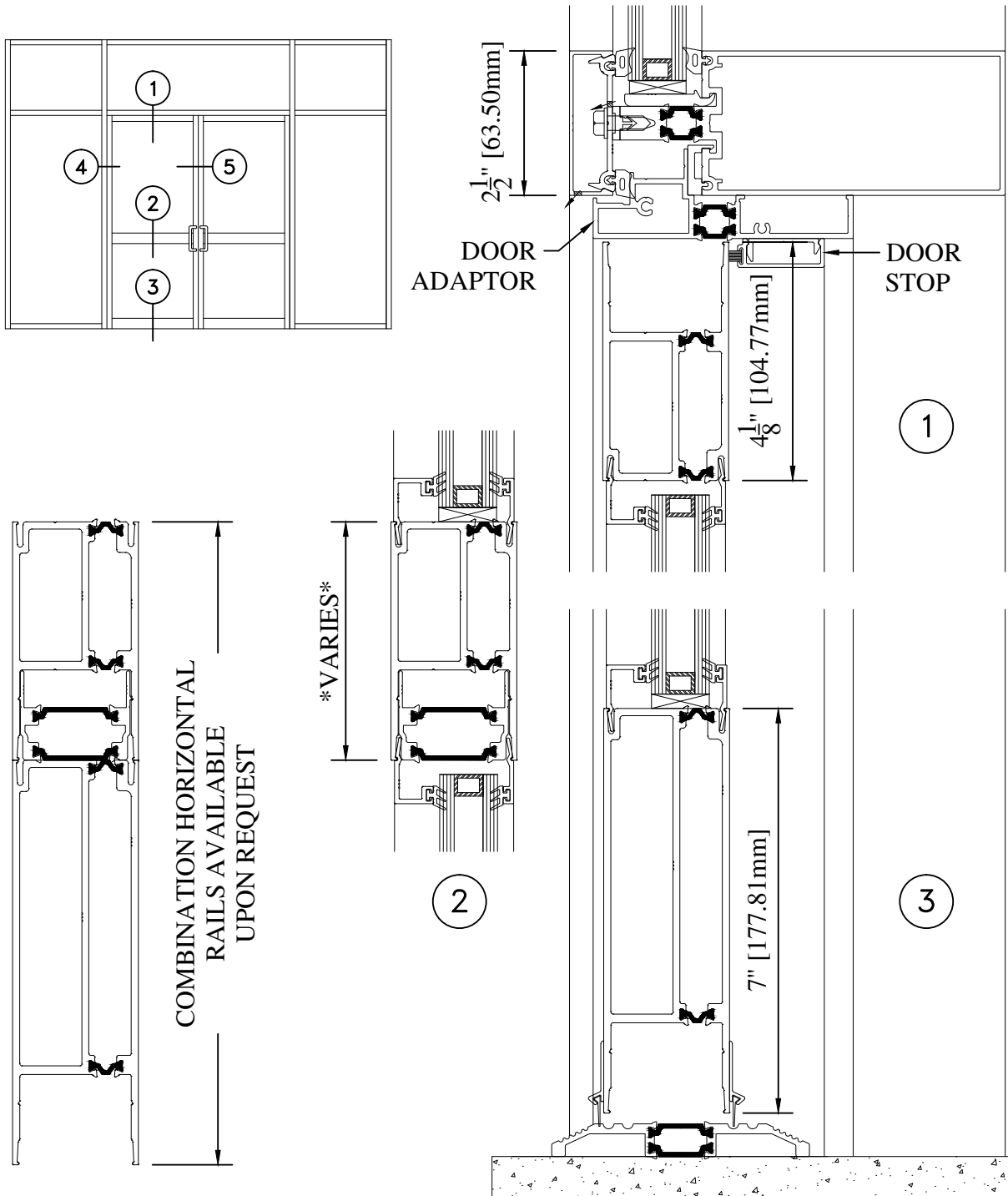

WINDSPEC INC.
MANUFACTURERS OF HIGH PERFORMANCE 'WINDSPEC' WINDOWS
ALUMINUM ENTRANCE SYSTEMS AND ARCHITECTURAL PANELS
1310 CREDITSTONE RD, CONCORD, ONTARIO L4K 5T7
Telephone (905) 738 -8311 Fax (905) 738 - 6188

FEBRUARY 2017

HTP DOOR

MEDIUM STILE IN HTP 5500

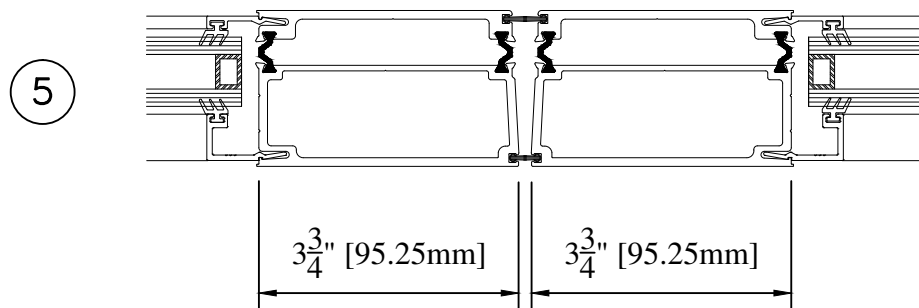
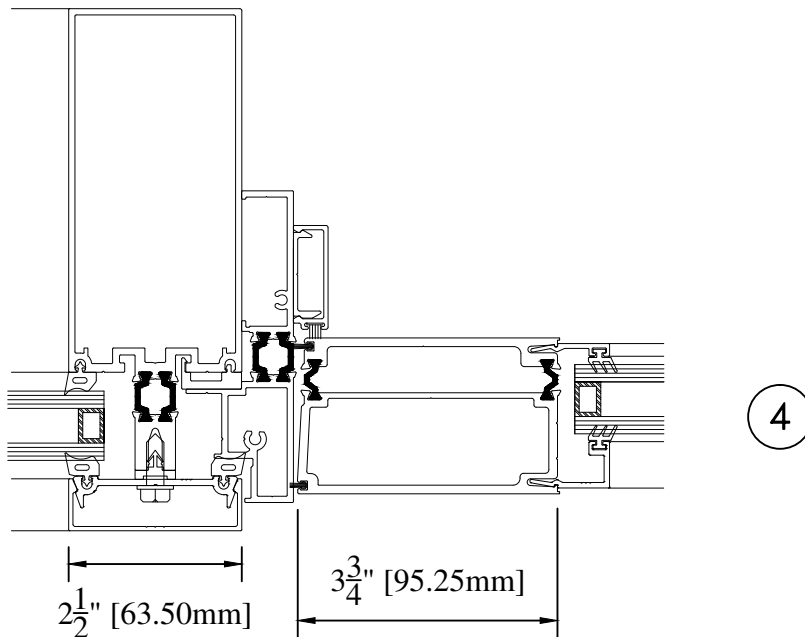

WINDSPEC INC.
MANUFACTURERS OF HIGH PERFORMANCE 'WINDSPEC' WINDOWS
ALUMINUM ENTRANCE SYSTEMS AND ARCHITECTURAL PANELS
1310 CREDITSTONE RD, CONCORD, ONTARIO L4K 5T7
Telephone (905) 738 -8311 Fax (905) 738 - 6188

FEBRUARY 2017

HTP DOOR

WIDE STILE IN HTP 5500

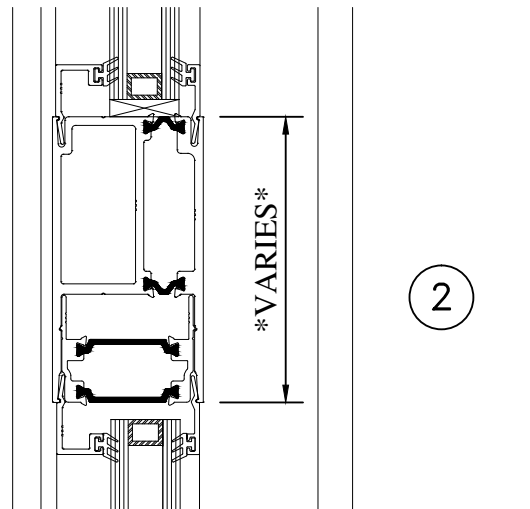
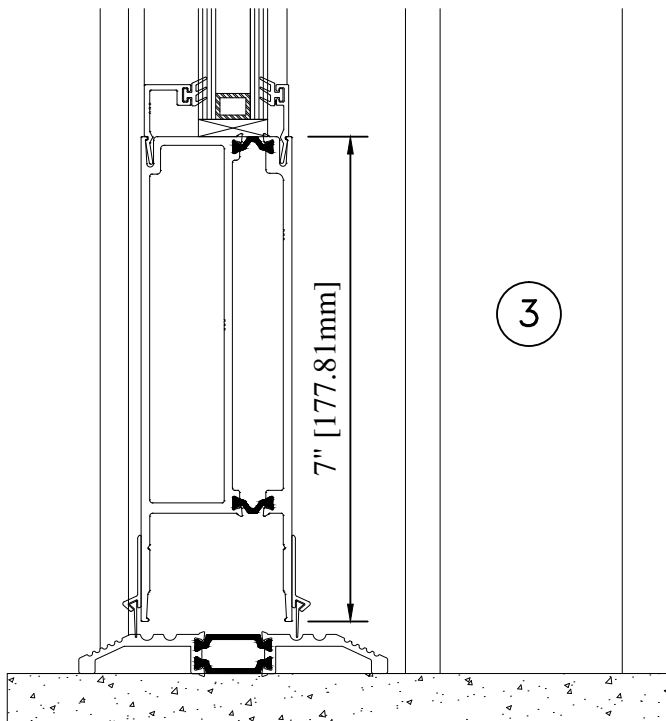
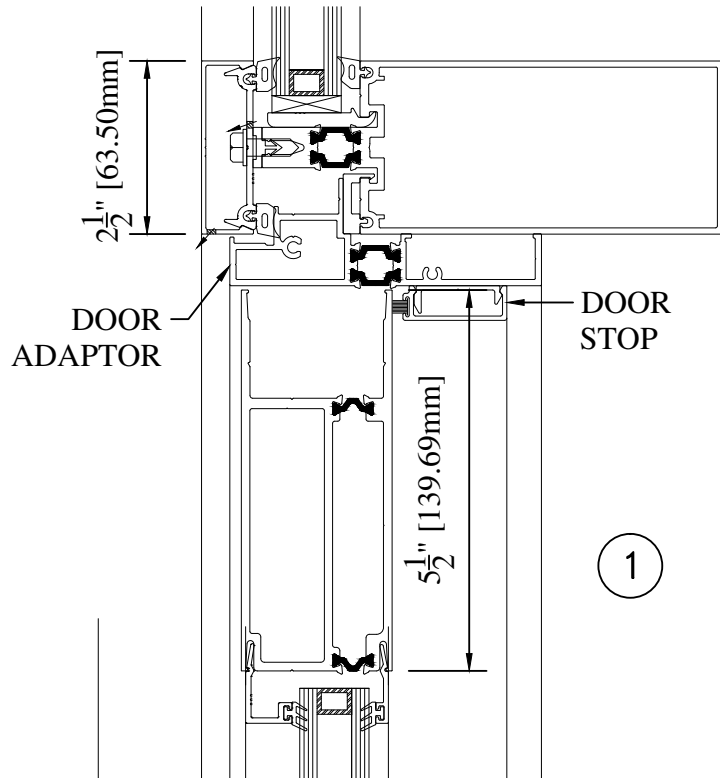
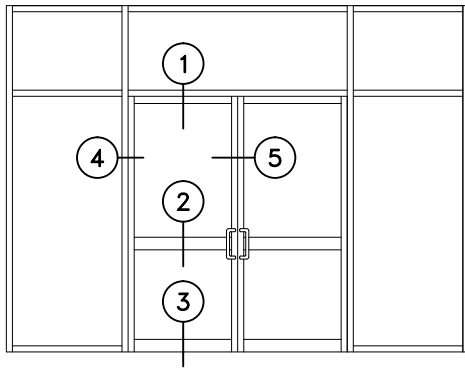

WINDSPEC INC.

MANUFACTURERS OF HIGH PERFORMANCE 'WINDSPEC' WINDOWS
ALUMINUM ENTRANCE SYSTEMS AND ARCHITECTURAL PANELS
1310 CREDITSTONE RD, CONCORD, ONTARIO L4K 5T7
Telephone (905) 738 -8311 Fax (905) 738 - 6188

FEBRUARY 2017

HTP DOOR

WIDE STILE IN HTP 5500

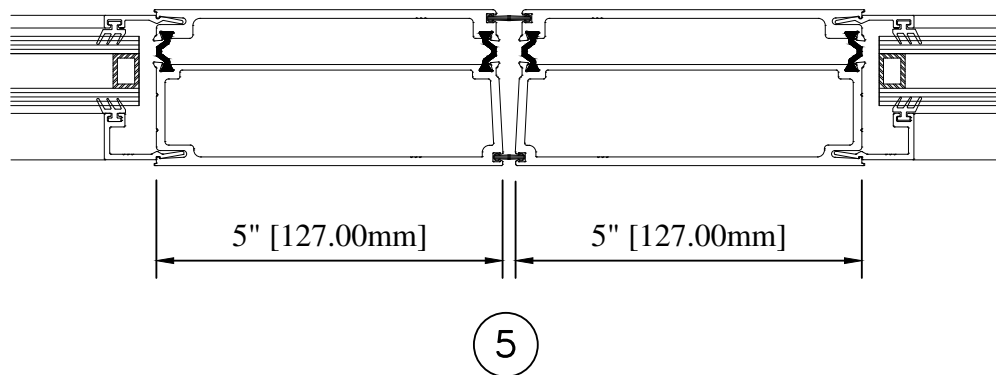
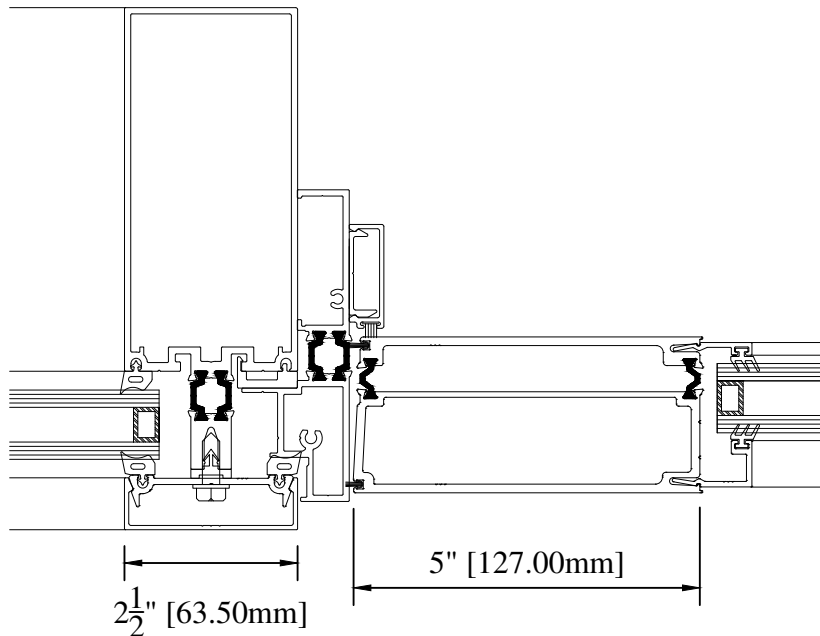

WINDSPEC INC.

MANUFACTURERS OF HIGH PERFORMANCE 'WINDSPEC' WINDOWS
ALUMINUM ENTRANCE SYSTEMS AND ARCHITECTURAL PANELS
1310 CREDITSTONE RD, CONCORD, ONTARIO L4K 5T7
Telephone (905) 738 -8311 Fax (905) 738 - 6188

FEBRUARY 2017

HTP DOOR

NARROW STILE IN 655 SERIES

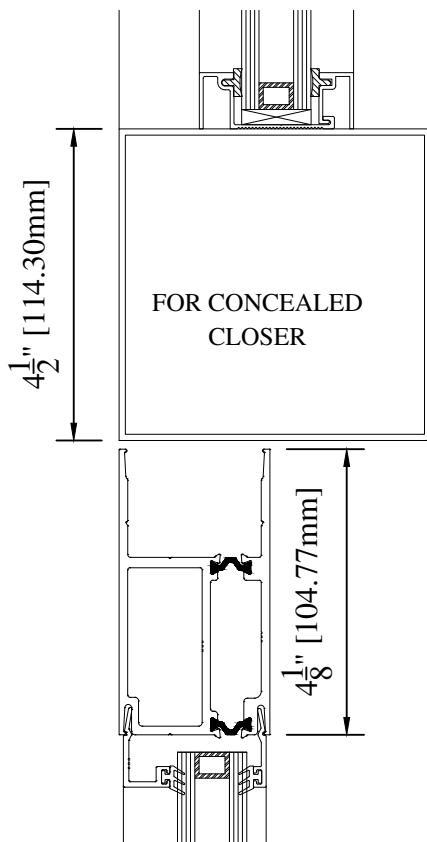
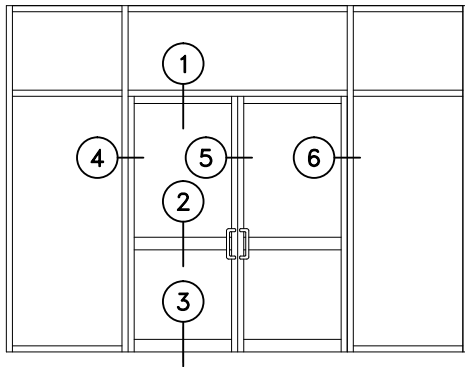

1a

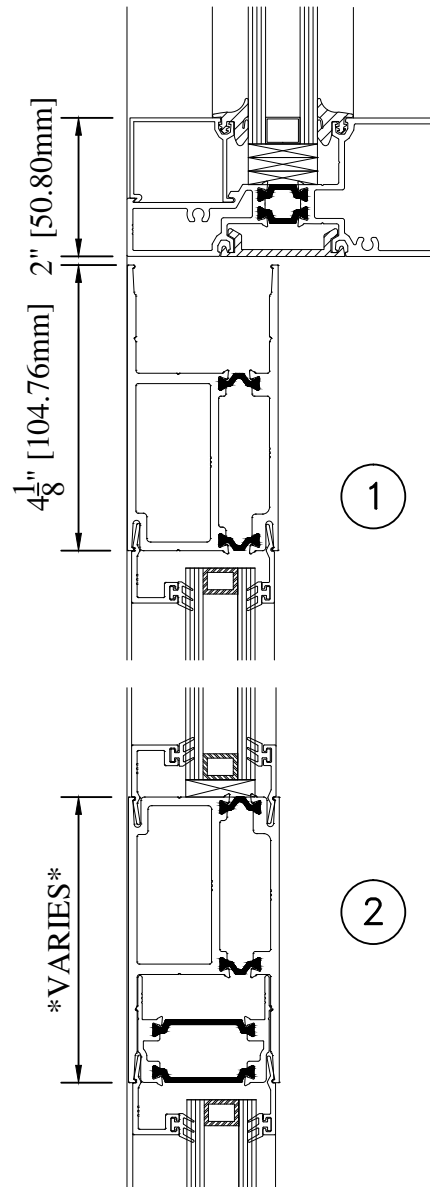

2



WINDSPEC INC.
MANUFACTURERS OF HIGH PERFORMANCE 'WINDSPEC' WINDOWS
ALUMINUM ENTRANCE SYSTEMS AND ARCHITECTURAL PANELS
1310 CREDITSTONE RD, CONCORD, ONTARIO L4K 5T7
Telephone (905) 738 -8311 Fax (905) 738 - 6188

FEBRUARY 2017

HTP DOOR

NARROW STILE IN 655 SERIES

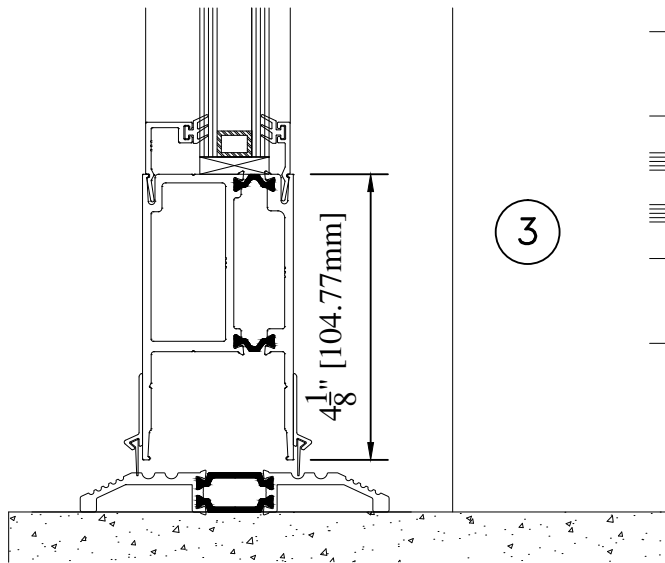

3

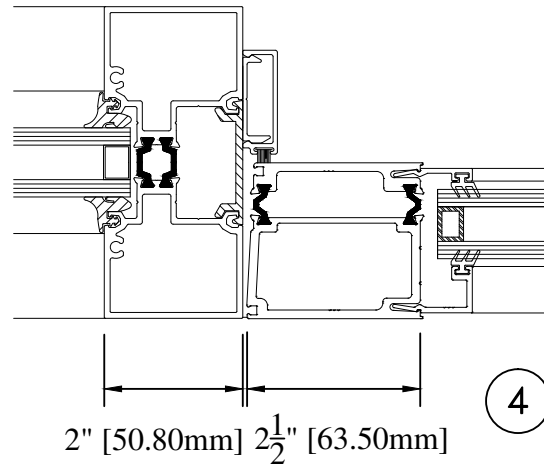

4

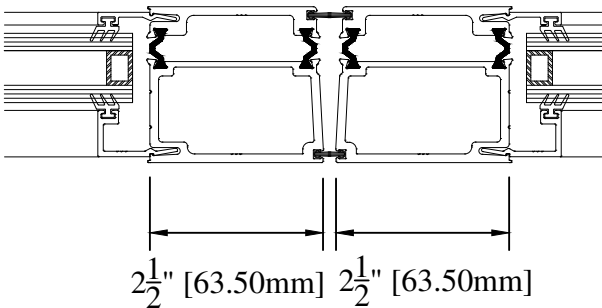

5

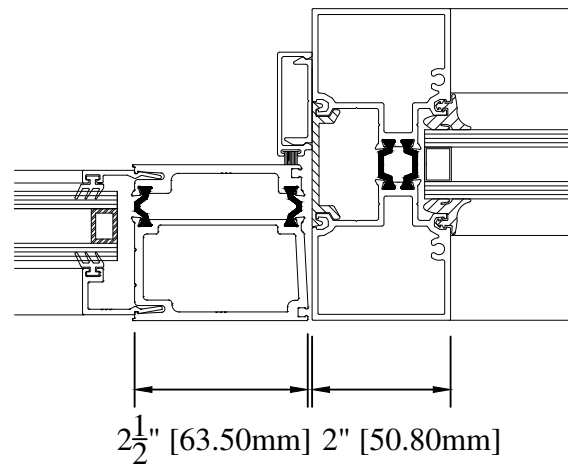

6



WINDSPEC INC.

MANUFACTURERS OF HIGH PERFORMANCE 'WINDSPEC' WINDOWS
ALUMINUM ENTRANCE SYSTEMS AND ARCHITECTURAL PANELS
1310 CREDITSTONE RD, CONCORD, ONTARIO L4K 5T7
Telephone (905) 738-8311 Fax (905) 738-6188

FEBRUARY 2017

HTP DOOR

MEDIUM STILE IN 655 SERIES

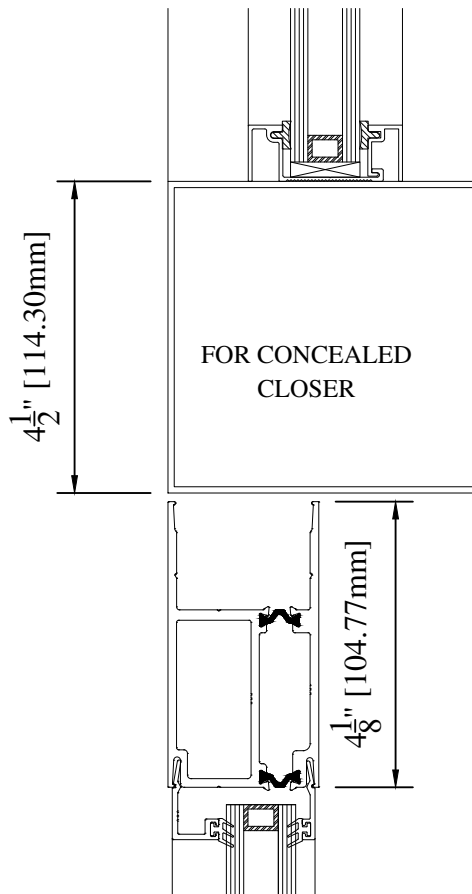
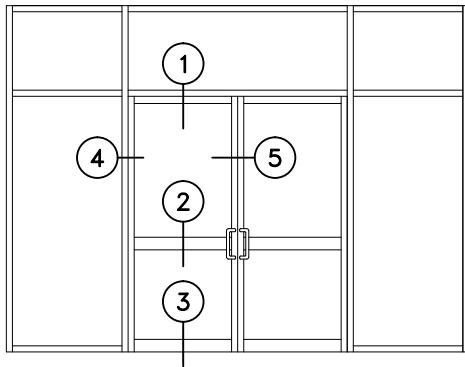

1a

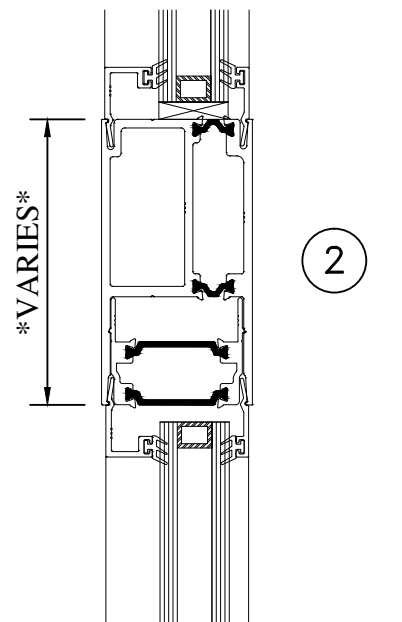
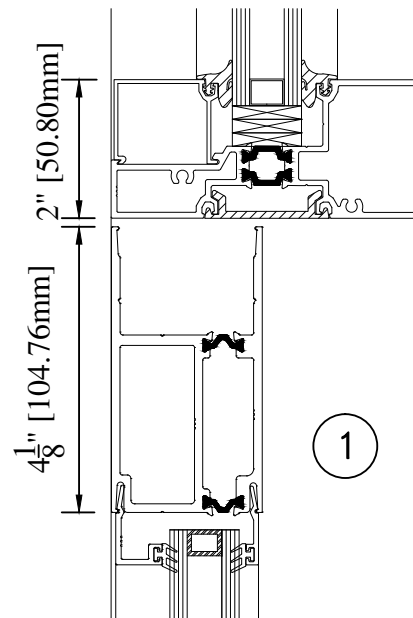

WINDSPEC INC.
MANUFACTURERS OF HIGH PERFORMANCE 'WINDSPEC' WINDOWS
ALUMINUM ENTRANCE SYSTEMS AND ARCHITECTURAL PANELS
1310 CREDITSTONE RD, CONCORD, ONTARIO L4K 5T7
Telephone (905) 738 -8311 Fax (905) 738 - 6188

FEBRUARY 2017

HTP DOOR

MEDIUM STILE IN 655 SERIES

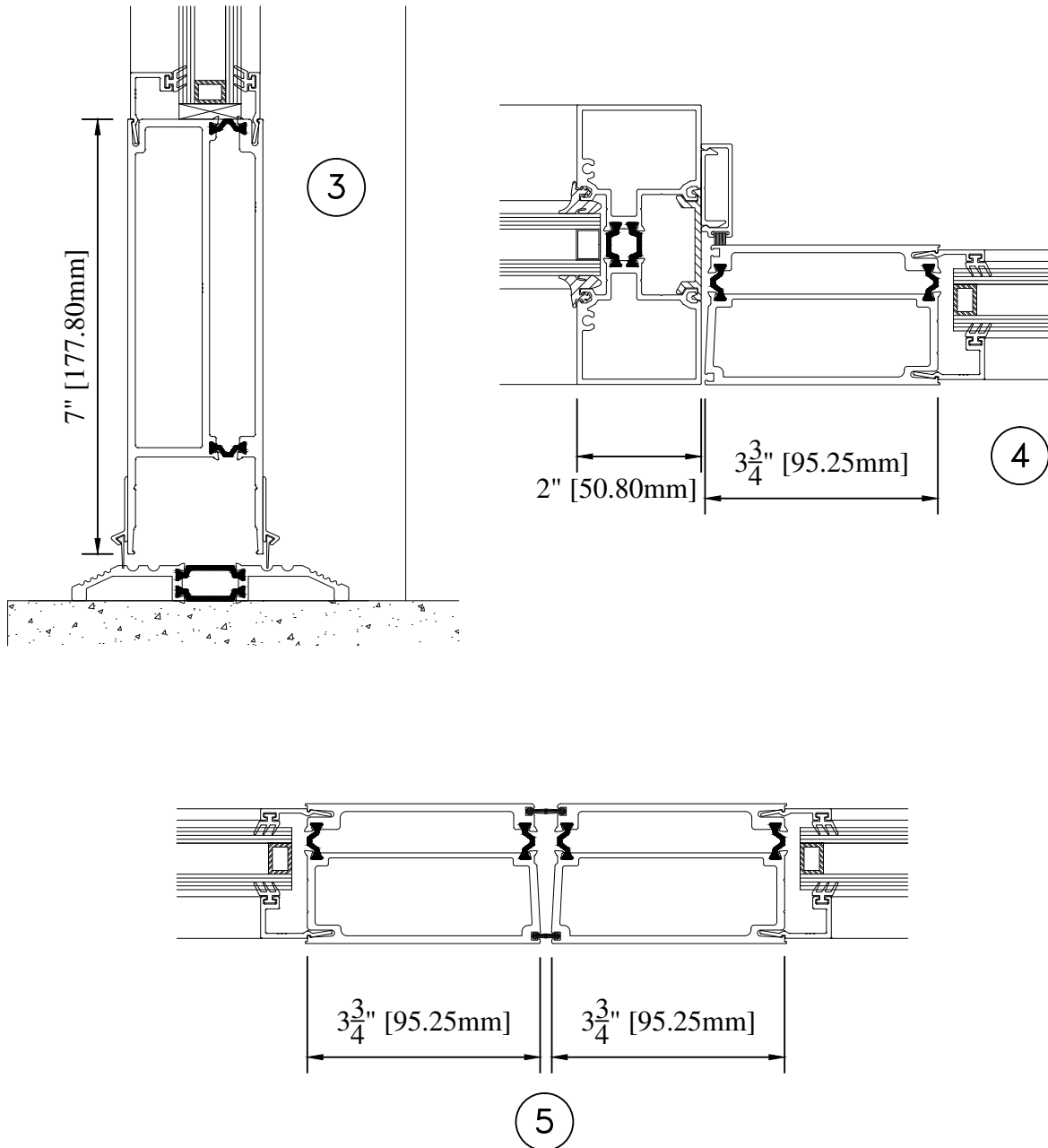

WINDSPEC INC.

MANUFACTURERS OF HIGH PERFORMANCE 'WINDSPEC' WINDOWS
ALUMINUM ENTRANCE SYSTEMS AND ARCHITECTURAL PANELS
1310 CREDITSTONE RD, CONCORD, ONTARIO L4K 5T7
Telephone (905) 738 -8311 Fax (905) 738 - 6188

FEBRUARY 2017

HTP DOOR

WIDE STILE IN 655 SERIES

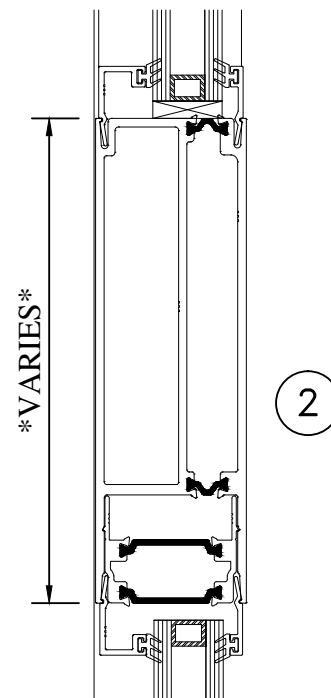
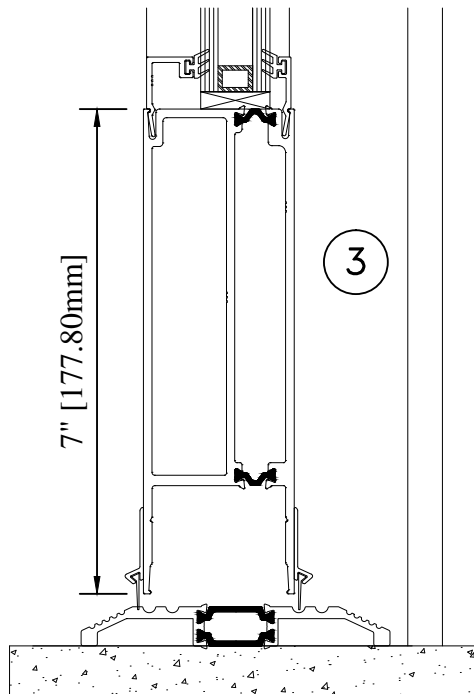
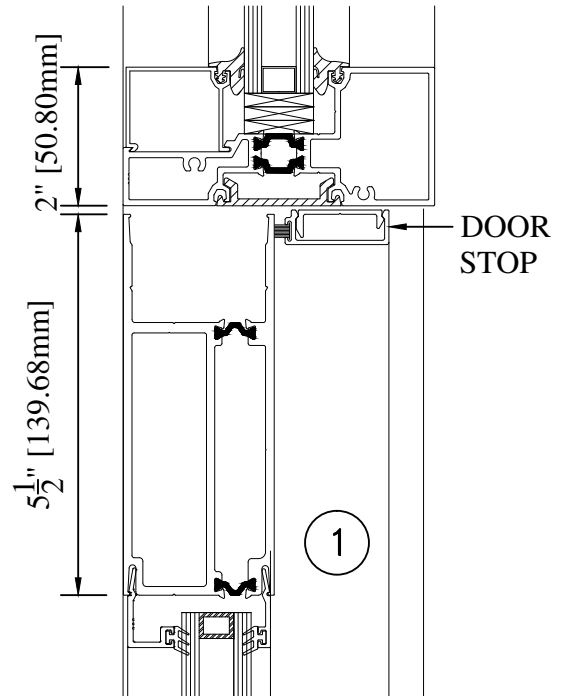
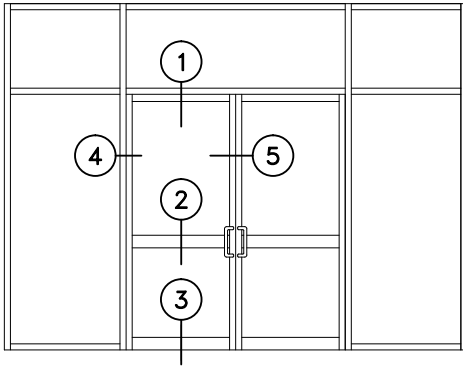

WINDSPEC INC.
MANUFACTURERS OF HIGH PERFORMANCE 'WINDSPEC' WINDOWS
ALUMINUM ENTRANCE SYSTEMS AND ARCHITECTURAL PANELS
1310 CREDITSTONE RD, CONCORD, ONTARIO L4K 5T7
Telephone (905) 738 -8311 Fax (905) 738 - 6188

FEBRUARY 2017

HTP DOOR

WIDE STILE IN 655 SERIES

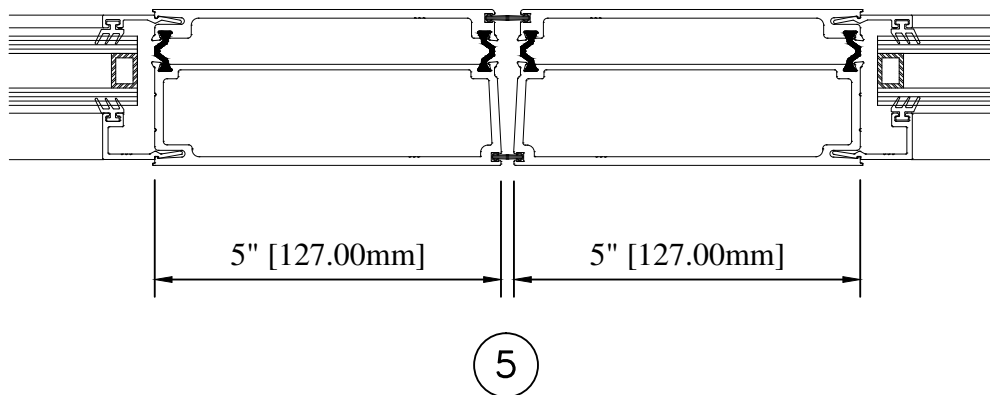
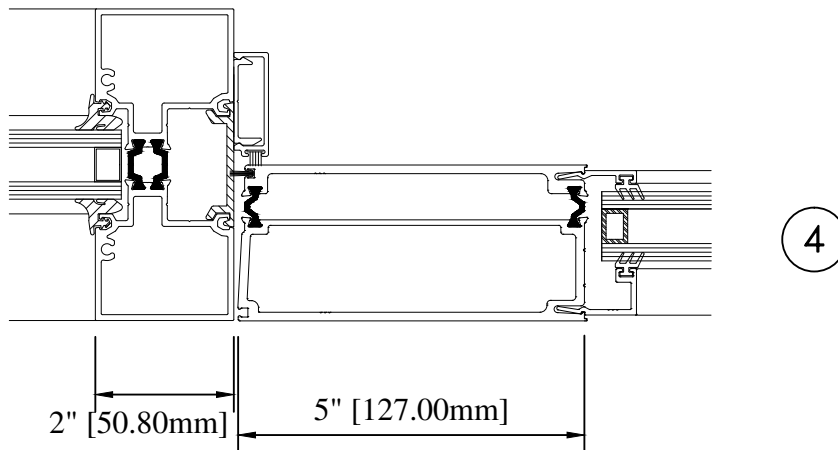

WINDSPEC INC.

MANUFACTURERS OF HIGH PERFORMANCE 'WINDSPEC' WINDOWS
ALUMINUM ENTRANCE SYSTEMS AND ARCHITECTURAL PANELS
1310 CREDITSTONE RD, CONCORD, ONTARIO L4K 5T7
Telephone (905) 738 -8311 Fax (905) 738 - 6188

FEBRUARY 2017

HTP DOOR

TRIPLE GLAZED HTP DOOR IN HTP 5500

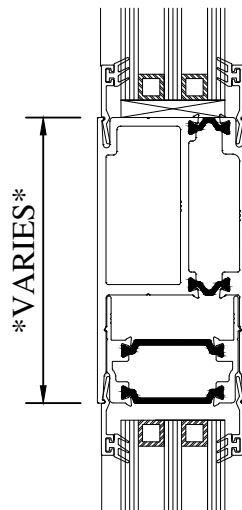
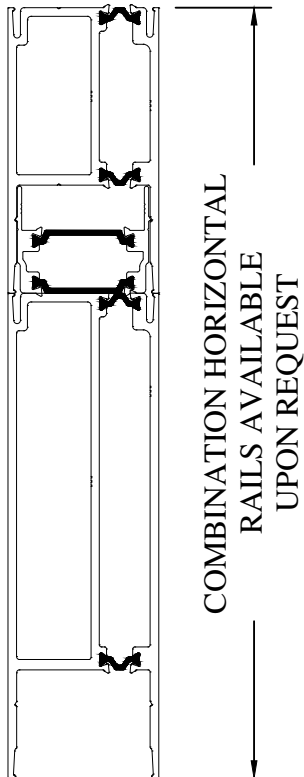
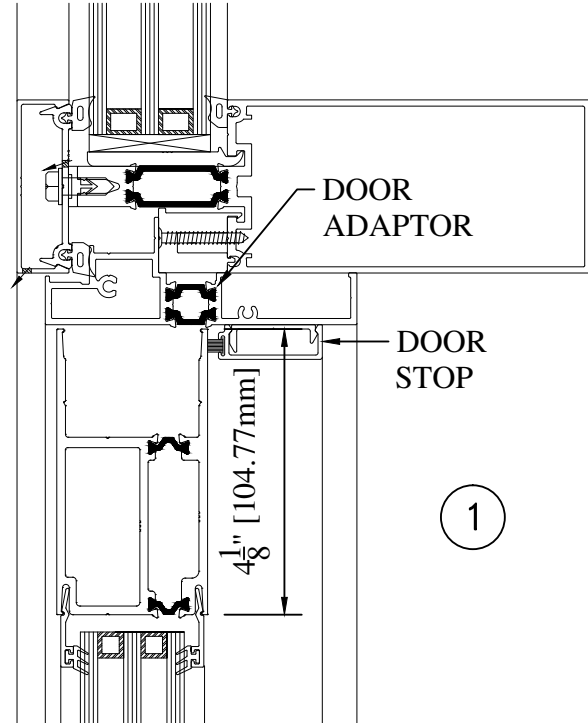
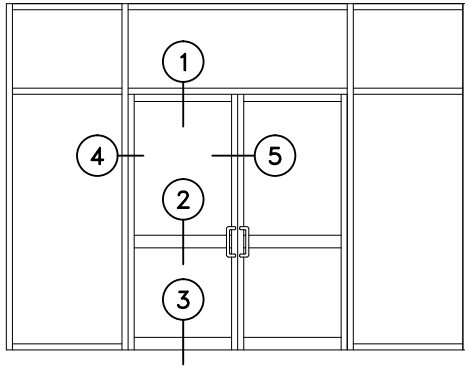

2

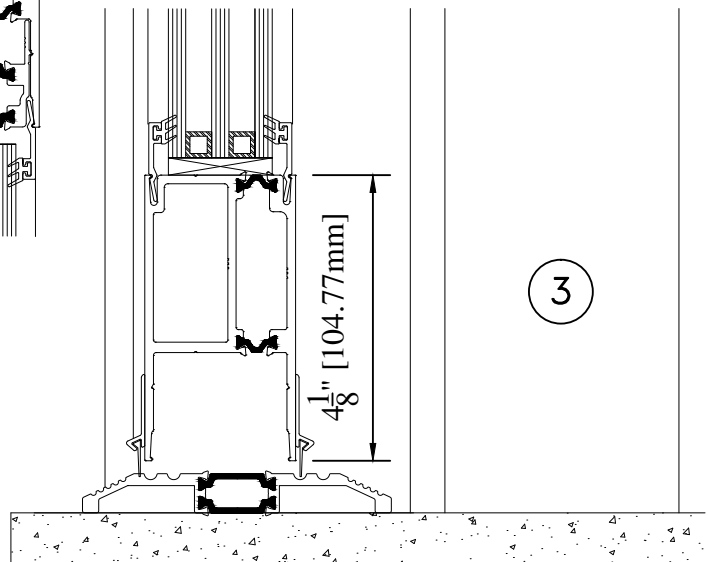

3



WINDSPEC INC.

MANUFACTURERS OF HIGH PERFORMANCE 'WINDSPEC' WINDOWS
ALUMINUM ENTRANCE SYSTEMS AND ARCHITECTURAL PANELS
1310 CREDITSTONE RD, CONCORD, ONTARIO L4K 5T7
Telephone (905) 738 -8311 Fax (905) 738 - 6188

FEBRUARY 2017

HTP DOOR

TRIPLE GLAZED HTP DOOR IN HTP 5500

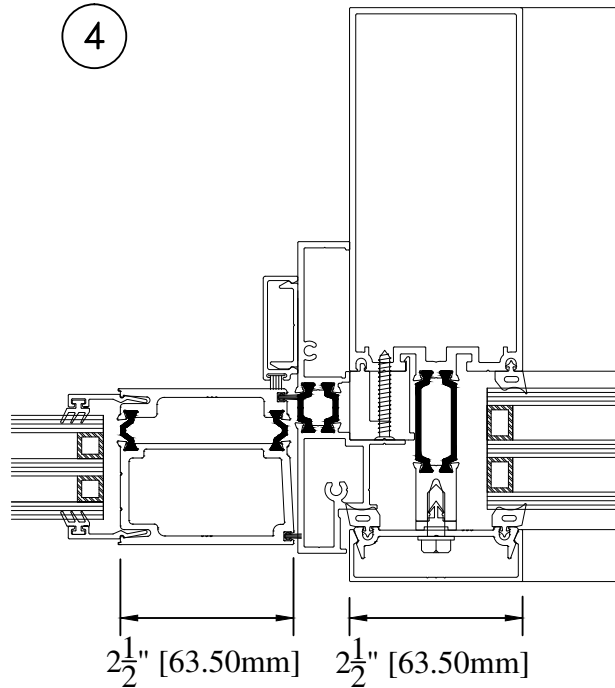
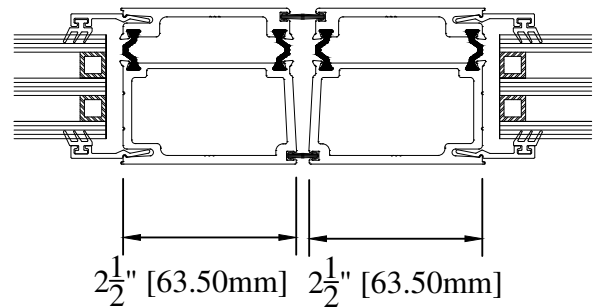
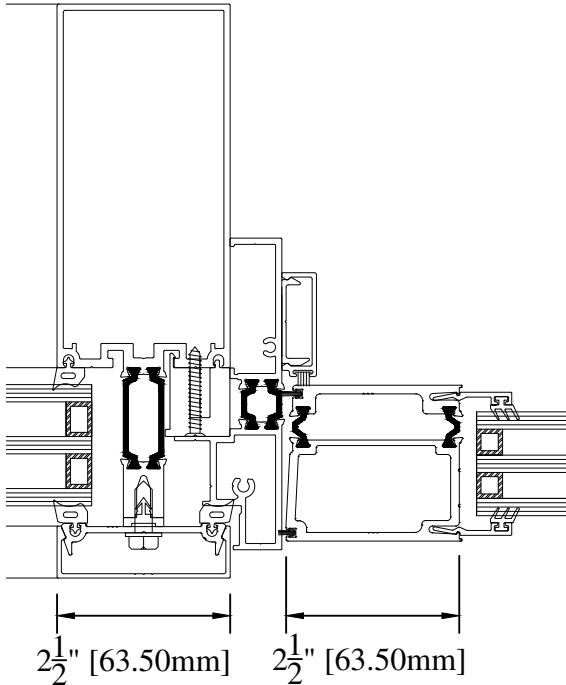

WINDSPEC INC.

MANUFACTURERS OF HIGH PERFORMANCE 'WINDSPEC' WINDOWS
ALUMINUM ENTRANCE SYSTEMS AND ARCHITECTURAL PANELS
1310 CREDITSTONE RD, CONCORD, ONTARIO L4K 5T7
Telephone (905) 738 -8311 Fax (905) 738 - 6188

FEBRUARY 2017

HTP DOOR

HTP DOOR STILES & HORIZONTAL RAILS

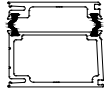
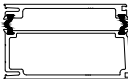
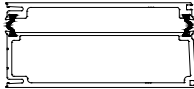
Vertical Stiles	Description
	HTP 250 Narrow Stile (2 1/2")
	HTP 375 Medium Stile (3 3/4")
	HTP 500 Wide Stile (5")

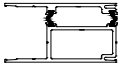
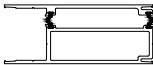
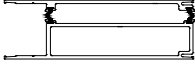
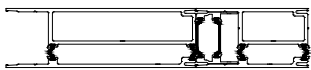
Horizontal Rails	Top/Bottom Rail	Mid Rail
1" 		*
4 1/8" 	*	*
5 1/2" 	*	*
7" 	*	*
11 1/8"  **Custom Combinations Available**	*	*



WINDSPEC INC.
MANUFACTURERS OF HIGH PERFORMANCE 'WINDSPEC' WINDOWS
ALUMINUM ENTRANCE SYSTEMS AND ARCHITECTURAL PANELS
1310 CREDITSTONE RD, CONCORD, ONTARIO L4K 5T7
Telephone (905) 738 -8311 Fax (905) 738 - 6188

FEBRUARY 2017